

## ***Coal Mine Prep Plant for RailWorks***

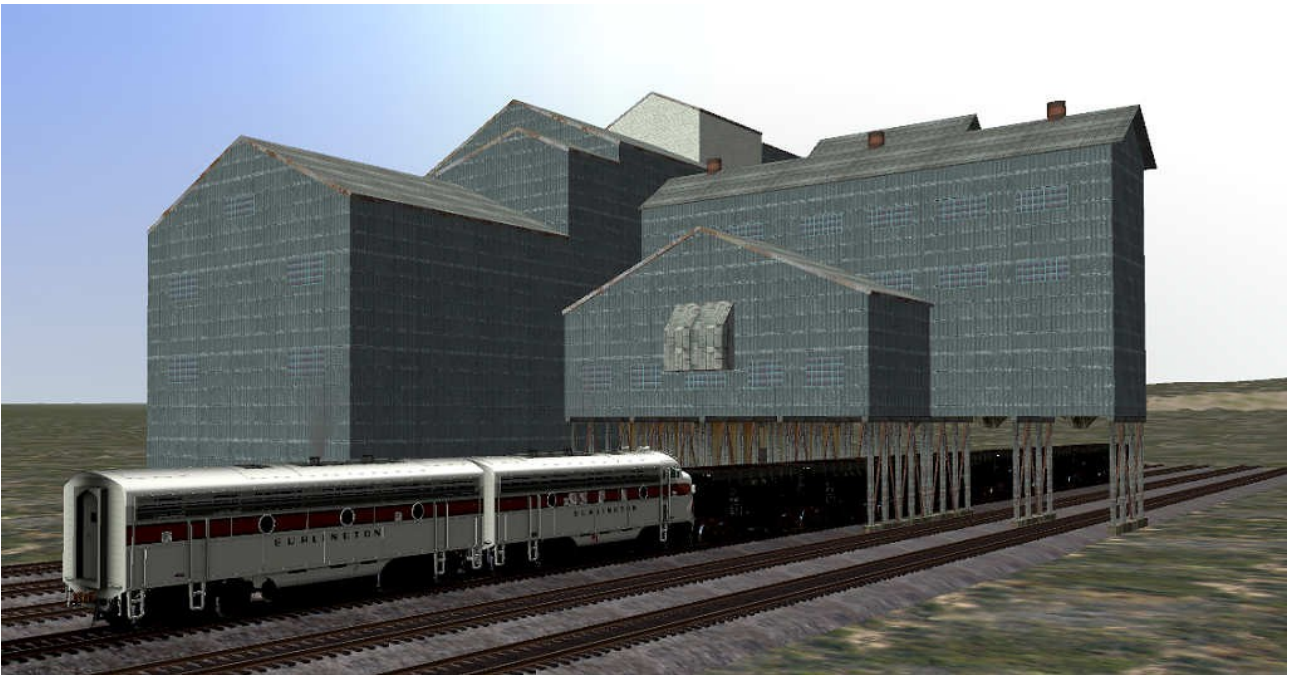

This is a freelanced model of a coal mine prep plant building, based on a real-world structure found on the Montour Railroad (Champion Prep Plant) and originally built for Richard Shirey's Montour route.

This model comes in three parts: the main building, the multi-track loadout building and a separate animated freight transfer point model (a simplified coal chute to be attached to the bottom of the loadout building) so you can actually use this model to load your hopper cars in the sim.

### **Installation:**

1. Download the .RWP files and save them in a secure place on your hard disk – just in case you might have to reinstall it at a later time.
2. Launch [RailWorks](#) and select the [Package Manager](#) on the Welcome Screen.
3. Click the [Install](#) button, browse to the file from step one, click [Open](#). The package will be installed now, after which you can already use the new assets in the game!
4. To be able to place the objects in a route, you will first have to enable the [object filter](#) (left-hand mid flyout window, button that shows a blue cube with an orange triangle) for developer "[GreatNortherner](#)", product "[SteamEra](#)".
5. You will now find the objects in the left-hand flyout assets browser, listed in the Commercial/Industrial group as "[MiningTown ...](#)"

## **Copyright, Repaints, Distribution, Warranty:**

All of the contents of this software are [copyrighted material](#). You may use and include them in route uploads as long as they are free of charge. You may not redistribute the entire software package itself (the .rwp file).

You can do repaints of the included objects and you are allowed to distribute them as long as it is free of charge. Actually, please feel encouraged to repaint these models and publish them. We need more variety in RailWorks!

If you wish to include the objects in a payware project of yours, please contact us first so we can make a deal.

This software is provided to you on an "as is" basis without any express or implied [warranty](#) of any kind.

One or more textures on this 3D model have been created with images from CGTextures.com. These images may not be redistributed by default, please visit [www.cgtextures.com](http://www.cgtextures.com) for more information.

Contact Information:

<http://www.golden-age-rails.com>  
[contact@golden-age-rails.com](mailto:contact@golden-age-rails.com)